



GROWTECH.
JAKARTA

PROPAK
INDONESIA

 **Better
Stands**
Moving away from
disposable stands *together*

Better Stands Package Program



WHAT IS **BETTER STANDS?**

What is Better Stands?



01

Minimise Disposable Stands

Encourage exhibitors to move away from disposable, single-use stands at events.

02

Increase reusable structures

High quality materials, constructed safely which can be reused for future events.

03

Long term program

Part of stand build regulations and divided into three key stages – Bronze, Silver and Gold. Helps to facilitate a gradual transition from disposable to reusable stands for all exhibitors.



DEFINITION OF A BETTER STAND



STAND CATEGORIES

✓ 100% Reusable

● Disposable

To achieve a given level, a stand has to have achieved all categories marked with a green tick being reusable.



		Category	Items	Disposable	Bronze	Silver	Gold
Reused	1	Stand structure and walls	Structure or framework of the stand, walls, panels for meeting rooms, backdrop.	●	✓	✓	✓
	2	Floor Platform	Structure of flooring (excluding surface, e.g., carpet).	●	✓	✓	✓
	3	Furniture and Equipment	Showcases, counters, chairs, tables, sofa, coffee table, cabinet, flyer stand, LED walls, TV, AV equipment and etc.	●	✓	✓	✓
	4	Lightings	All kinds of lightings in the stand and showcases.	●	✓	✓	✓
	5	Fascia	Overhead signage or branding, fascia, company logo on top of the stand structure.	●	●	✓	✓
	6	Rigging structure	Hanging structure for stand branding or support	●	●	✓	✓
	7	Ceiling	Ceiling structure for lightings or for stand support.	●	●	✓	✓
	8	Display facilities	Lightboxes, shelves, doors and etc	●	●	✓	✓
Reused or Recycled	9	Flooring	Carpet, other floor coverings.	●	●	●	✓
	10	Decorative Signage	Laminate stickers, fabric, paper board, foamboard, posters, standing banners and etc	●	●	●	✓

STAND CATEGORIES



- ✓ 100% Reusable
- Disposable

To achieve a given level, a stand has to have achieved all categories marked with a green tick being reusable.

	Category	Items
Reused	1	Stand structure and walls Structure or framework of the stand, walls, panels for meeting rooms, backdrop.
	2	Floor Platform Structure of flooring (excluding surface, e.g., carpet).
	3	Furniture and Equipment Showcases, counters, chairs, tables, sofa, coffee table, cabinet, flyer stand, LED walls, TV, AV equipment and etc.
	4	Lightings All kinds of lightings in the stand and showcases.
	5	Fascia Overhead signage or branding, fascia, company logo on top of the stand structure.
	6	Rigging structure Hanging structure for stand branding or support
	7	Ceiling Ceiling structure for lightings or for stand support.
	8	Display facilities Lightboxes, shelves, doors and etc
Reused or Recycled	9	Flooring Carpet, other floor coverings.
	10	Decorative Signage Laminate stickers, fabric, paper board, foamboard, posters, standing banners and etc



YOUR BENEFITS



BENEFIT #1 SUSTAINABLE CHAMPION



- Promotes brand in positive light by highlighting sustainable qualities
- Part of the collective effort to reduce exhibition waste.



BENEFIT #2 CHEAPER & FASTER BOOTH



- Smoother & stress-free build & breakdown experience
- Reduced cost of design & stand constructions



BENEFIT #3 DEDICATED MARKETING CAMPAIGN



SUSTAINABILITY E-NEWSLETTER

Scheduled dedicated sustainability topic in regular intervals.

SOCIAL MEDIA POSTS

Dedicated social media posts to highlight each company taking part.

ON-SITE BRAND HIGHLIGHT

Inclusion in daily video highlight & marketing campaign





STAND DESIGNS

IDR 1.250.000 / sqm

USD 90 / sqm

**price is subject to tax
price is exclude space only price

**Designs are subject to change without prior notice.*

Wanindo

Type A



BOOTH 600X 300 TYPE A

1	PREMIUM BOOTH TYPE A		
1.1	Construction by maxima 8x8	h. 250cm	
1.2	Tower construction by maxima 8x8 fin printing sticker	h. 150cm	
1.3	Storage with folding door		
1.4	Flooring by needle punch carpet		
1.5	Information counter	100x50x100cmH	
1.6	Glass top round table	d. 85cm, h. 75cm	
1.7	Folding chair		
1.8	Barstool		
1.9	Waste paper basket		
1.10	Brochure rack		
1.11	High Showcase	100x50x200	
1.12	Low showcase	100x50x100cmH	
1.13	Fluorescent tube lamp inside storage		inside storage
1.14	Spotlight halogen for tower		
1.15	MCB 10amp/1ph + socket 1 hole		
1.16	Logo company at tower		printing sticker
1.17	Logo company at info counter	100x100	printing sticker
1.18	Poster at back wall	90x100	printing sticker
	ADDITIONAL		
1	TV 42 " + breket		
2	Long arm spotlight for poster		
3	MHL 150 wall for general lighting		
4	Printing poster 90 x 100 cm + intall stick on the wall		

29th PROPOSED DESIGN

Rev.	Page:	Event :	Date :	Venue :	Half/No. Stand :	Mu/Ds :
00	00	VAP SHOW 2022	20-22 OKTOBER	JEXPO	11- BL C1 C2	08/08

IndoOrima
PT. WANINDO EST
Y.KAN

BOOTH 600 X 600 TYPE B

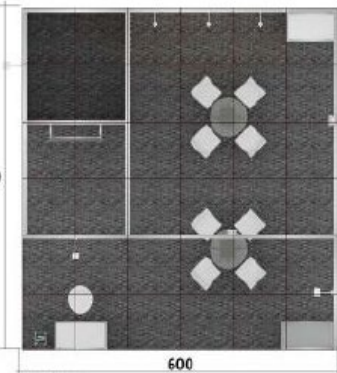
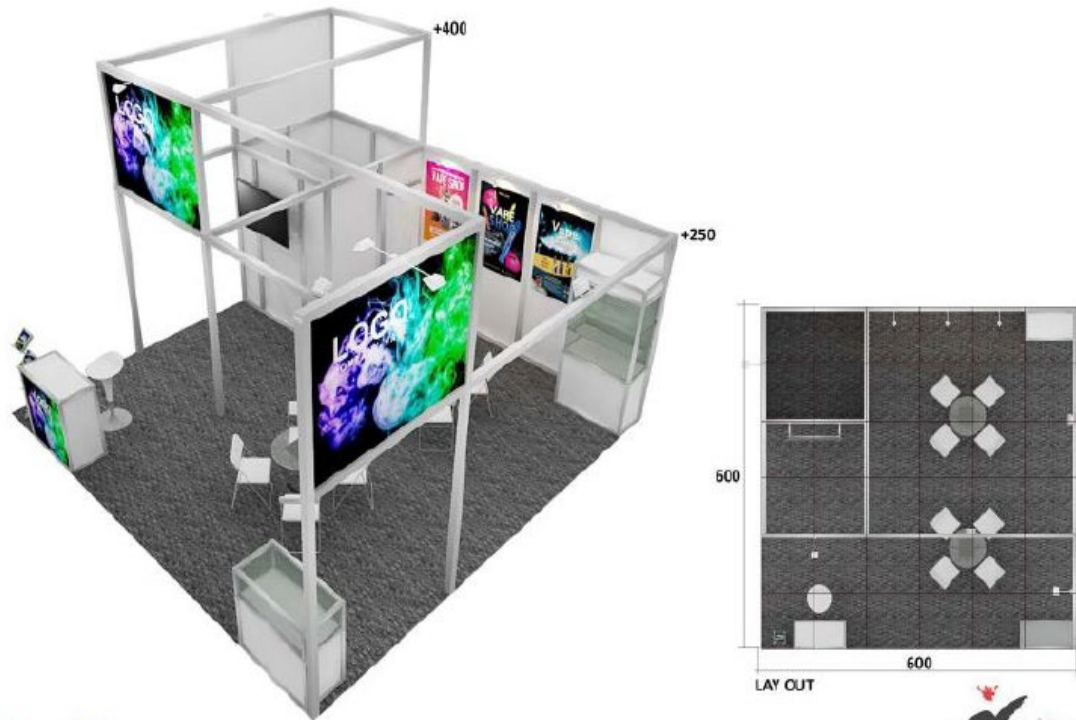

2	PREMIUM BOOTH TYPE B		
2.1	Construction by maxima 8x8	h. 250cm	
2.2	Tower construction by maxima 8x8 fin printing sticker	h. 150cm	
2.3	Storage with folding door		
2.4	Flooring by needle punch carpet		
2.5	Information counter	100x50x100cmH	
2.6	Glass top round table	d. 85cm, h. 75cm	
2.7	Folding chair		
2.8	Barstool		
2.9	Waste paper basket		
2.10	Brochure rack		
2.11	High Showcase	100x50x200	
2.12	Low showcase	100x50x100cmH	
2.13	Fluorescent tube lamp inside storage		inside storage
2.14	Spotlight halogen for tower		
2.15	MCB 10amp/1ph + socket 1 hole		
2.16	Logo company at tower		printing sticker
2.17	Logo company at info counter	100x100	printing sticker
	ADDITIONAL		
1	TV 42 " + breket		
2	Long arm spotlight for poster		
3	MHL 150 wall for general lighting		
4	Printing poster 90 x 100 cm + intall stick on the wall		

29th PROPOSED DESIGN

Rev.	Page:	Event :	Date :	Venue :	Hall No. Stand :	Ms.Ds :
00	00	VAPE SHOW 2022	20-22 OCTAER	JI EXPO	B1- B1, C1- C2	INDOPRIMA PT. MANIRICO PR YAN

Type C

BOOTH 600 X 300 TYPE C



29th

PROPOSED DESIGN

Rev: 00 | Page: 00 | Event: VAPE SHOW 2022 | Date: 20.22 OCTOBER | Venue: JI FKP | Hall/No. Stand: 61, 62, 63, 64 | Mo/Ds: 08/08



3	PREMIUM BOOTH TYPE C		
3.1	Construction by maxima 8x8	h. 250cm	
3.2	Tower construction by maxima 8x8 fin printing sticker	h. 150cm	
3.3	Storage with folding door		
3.4	Flooring by needle punch carpet		
3.5	Information counter	100x50x100cmH	
3.6	Glass top round table	d. 85cm, h. 75cm	
3.7	Folding chair		
3.8	Barstool		
3.9	Waste paper basket		
3.10	Brochure rack		
3.11	High Showcase	100x50x200	
3.12	Low showcase	100x50x100cmH	
3.13	Fluorescent tube lamp inside storage		inside storage
3.14	Spotlight halogen for tower		
3.15	MCB 10amp/1ph + socket 1 hole		
3.16	Logo company at tower		printing sticker
3.17	Logo company at info counter	100x100	printing sticker



**Better
Stands**

Moving away from
disposable stands *together*

BE PART OF OUR COLLECTIVE EFFORT TO REDUCE DISPOSABLE STAND!

Please contact our sales team:
Dara Andina (Ms)
E: dara.andina@pamerindo.com



Thank you

We love to hearing your feedback and/or ideas on how we can be more environmentally friendly at exhibitions.

Let our team know!

Tari Lestari

E: tari.lestari@pamerindo.com